



## 252 Hastings Bay Esplanade HASTINGS TAS

2 🏠 3 🚗 10 🚗

Located in one of the Southernmost parts of Australia is a haven hard to beat. From the moment you enter the property, your mind clarifies and unwinds from the hustle and bustle of today's frantic world. Solar passive is what springs to mind as I begin to describe the many features this property has to offer. The property is completely off grid and incorporates solar electricity (12 x Sonnenschein batteries, 8 x solar panels with back up, diesel generator to powerhouse and shed at 240 volts). Hot water and gas cooking is via bottled gas and there are 3 gas points connected to accompany the free standing wood heater in the colder months if required. All windows and sliding doors are double glazed and the home is fully insulated. The galley style kitchen is well appointed with a large pantry, stainless steel appliances and two entry points for

**Type** : House  
**Price** : \$1,375,000  
**Building Size** : 18 Sqrs  
**Land Size** : 56100 sqm  
**View** : <https://www.taspr.com.au/8027006>



**Renee Vanson**  
**03 6264 2888**

[For full version visit the website](https://www.taspr.com.au)

<https://www.taspr.com.au>

(03) 6264 2888

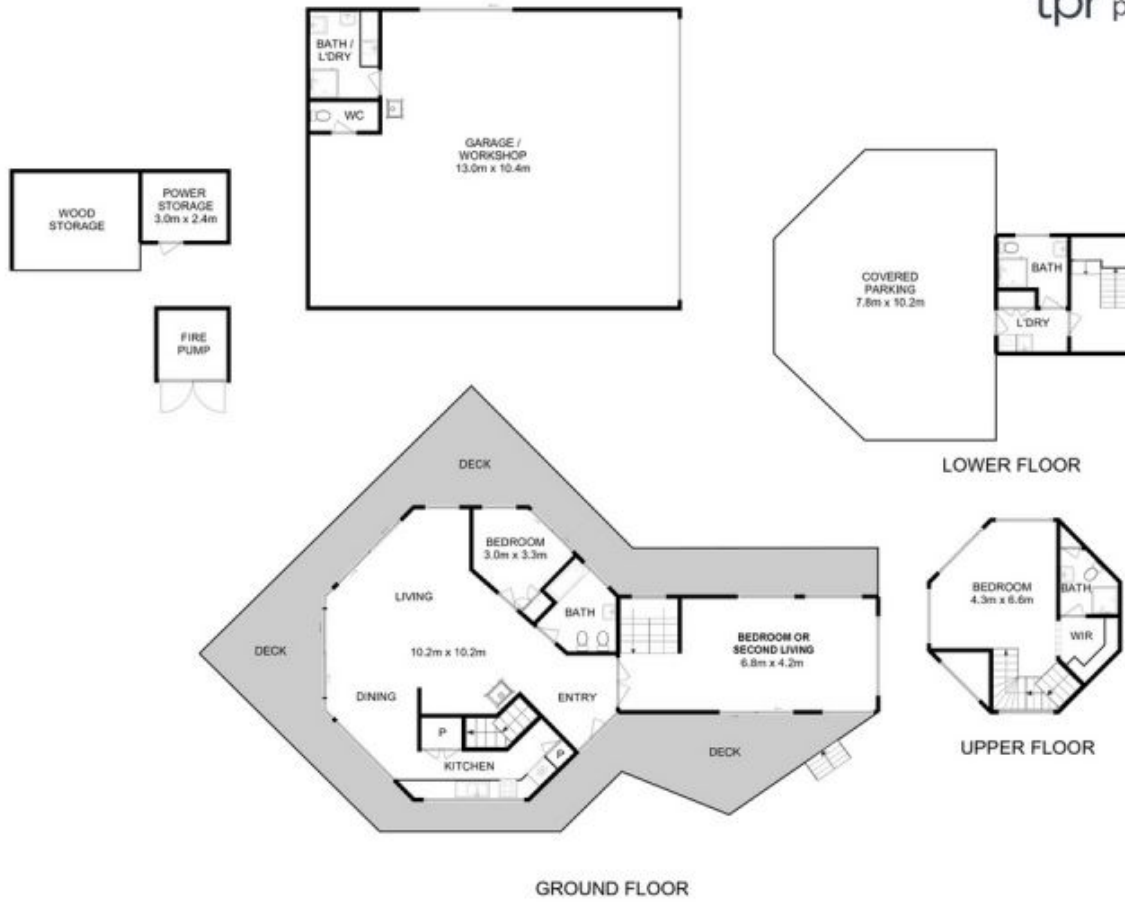

Total Approx. Floor Area : 189 sqm  
 Total Approx. Outbuilding Area : 172 sqm

All measurements are internal and approximate.  
 This plan is a sketch for illustration, not valuation.  
 Produced by Open2view.com

