



7 Pearl Court DOVER TAS

3 2 4

Step into your new residence knowing there is nothing to do but simply enjoy! This beautifully presented property is as new, with light décor, a feeling of space and light with a fabulous orientation to enjoy all day sun. The open plan living leads out to a sizeable timber deck with uninterrupted water views, and there is a rear entertaining area for alfresco dining. All three bedrooms offer ample storage, and the spacious kitchen is a delight for the chef of the home to enjoy. The main bathroom and ensuite are well appointed, and there is ample storage throughout the residence. The home has a 7.4-star energy efficiency rating with a pellet heater, a reverse cycle air conditioner, and a great orientation so the home is both comfortable and energy efficient throughout the year.

Type : House
Price : \$ 780,000
Building Size : 126 sqm
Land Size : 1260 sqm
View : <https://www.taspr.com.au/8096312>



Renee Vanson
03 6264 2888

[For full version visit the website](https://www.taspr.com.au)

<https://www.taspr.com.au>

(03) 6264 2888

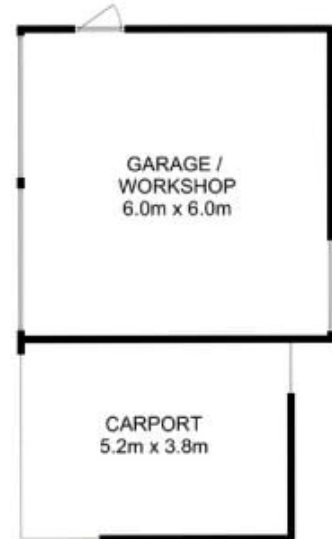
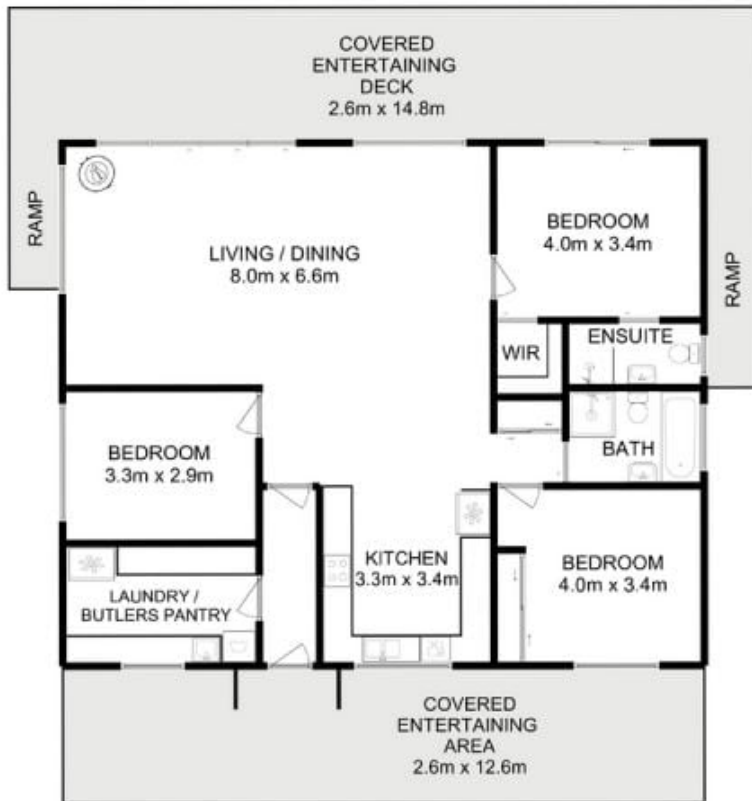

Total Approx. Floor Area : 130 sqm
Total Approx. Outbuilding Area : 57 sqm

All measurements are internal and approximate.
This plan is a sketch for illustration, not valuation.
Produced by Open2view.com